

SORT IT OUT!

Did you know that beans are seeds? Seeds grow into plants that produce the beans we eat! Do you eat these beans/seeds?

How many seeds do you think are in your cup?

We think there are _____ seeds.

Sort your seeds into groups. Count each group.

Add all the seed groups together. We count _____ seeds in all.

Record this information on your Seed Graph.

Directions

Students work in pairs to complete the activities on the four worksheets.

Materials pair of students

- ½ cup assorted seeds (soybean, lima, corn, pinto, black-eyed, kidney)
- Pencil
- 1 of each seed sort worksheets

Lima: ____

Kidney: ____

Blackeye: ____

Soybean: ____

Pinto: ____

Corn: ____

Put all your seeds here in the center, then sort them into the smaller areas.

CHART IT OUT!

Seed graph

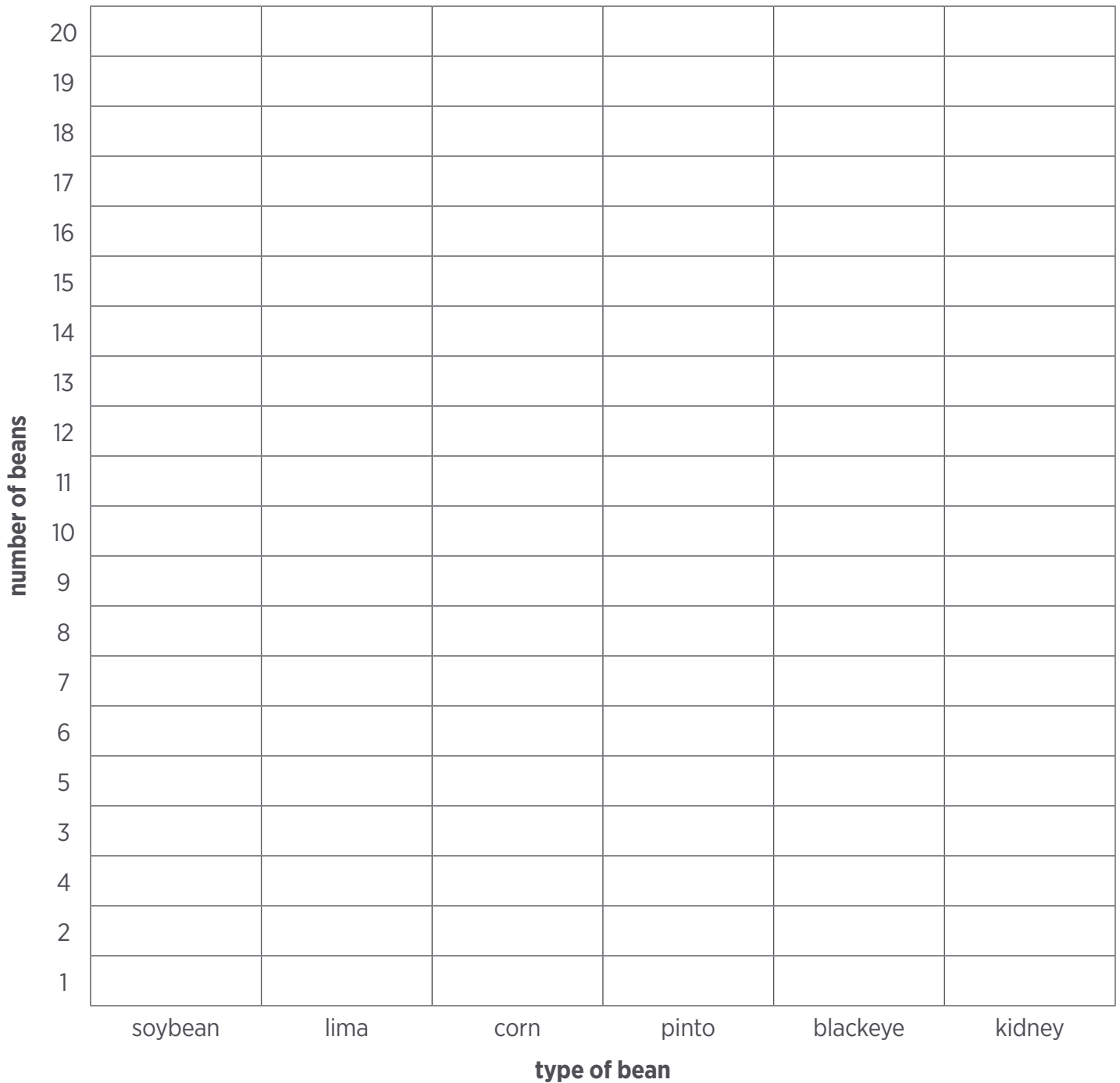

What does this graph say?

MAP IT OUT!

Seed sorting map

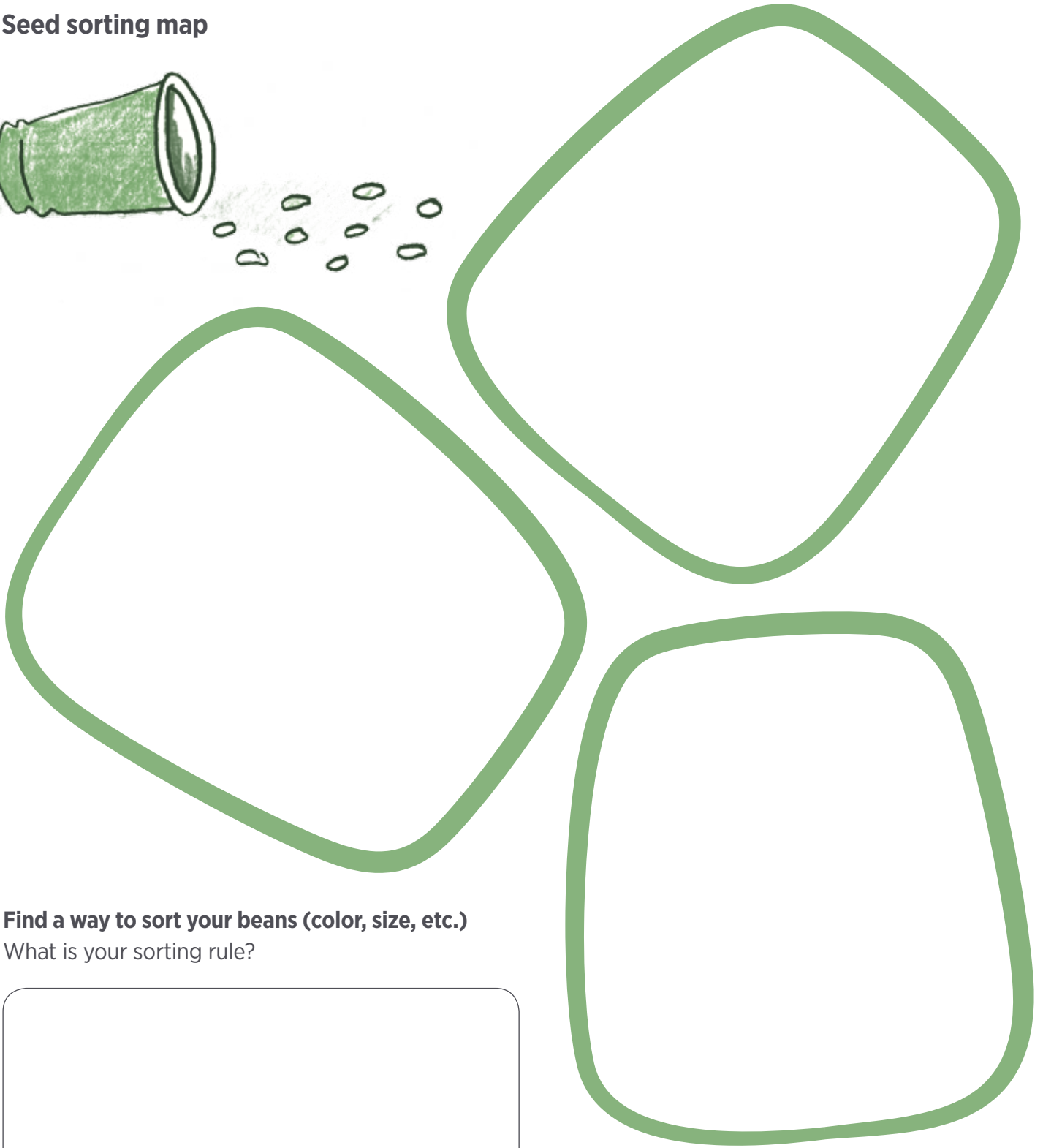

Find a way to sort your beans (color, size, etc.)

What is your sorting rule?

CHECK IT OUT!

Observing seeds

Look closely at your seeds. Name the colors that you see. Draw the shapes of the seeds.

	colors	shapes
Lima		
Soybean		
Corn		
Pinto		
Blackeye		
Kidney		

How many seeds does it take to cover this line?



	I think...	I count...
Lima		
Soybean		
Corn		
Pinto		
Blackeye		
Kidney		

